

G		SHEET 1 OF 1		10-730186-() (REV. 1)	
REVISIONS					
REV	DESCRIPTION	DATE			
D	ADD KEYWAY DESIGN ADD CODE NUMBER	2016-03-28			
E	UPDATE TEMP. AND CABLE RANGE	2016-11-11			
F	CHANGE WIDTH OF BUTTON SLOT	2017-03-24			
G	UPDATE CABLE RANGE	2017-04-26			

GENERAL TOLERANCE					
DIM. RANGE	0.5 ~ 3	> 3 ~ 6	6 ~ 30	30 ~ 120	120 ~ 400
TOLERANCE	±0.1	±0.1	±0.2	±0.3	±0.5

CUSTOMER DRAWING

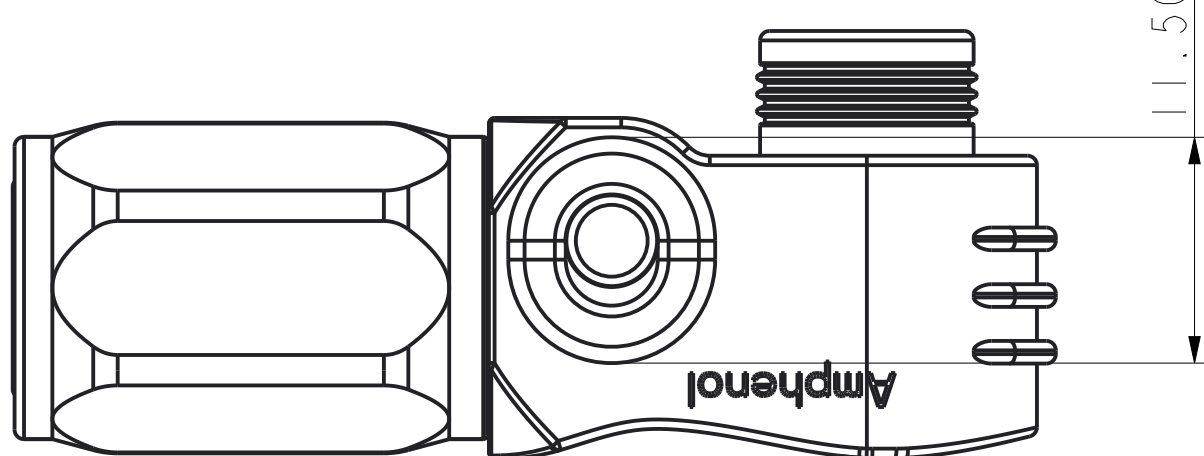
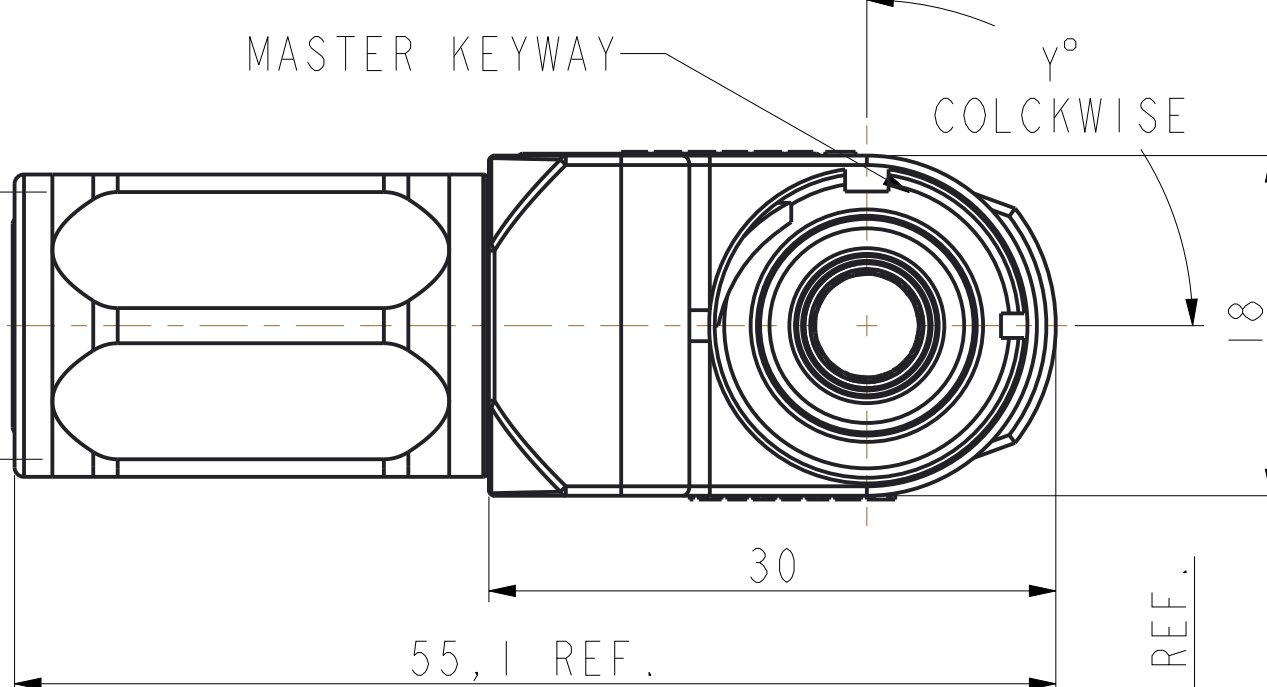
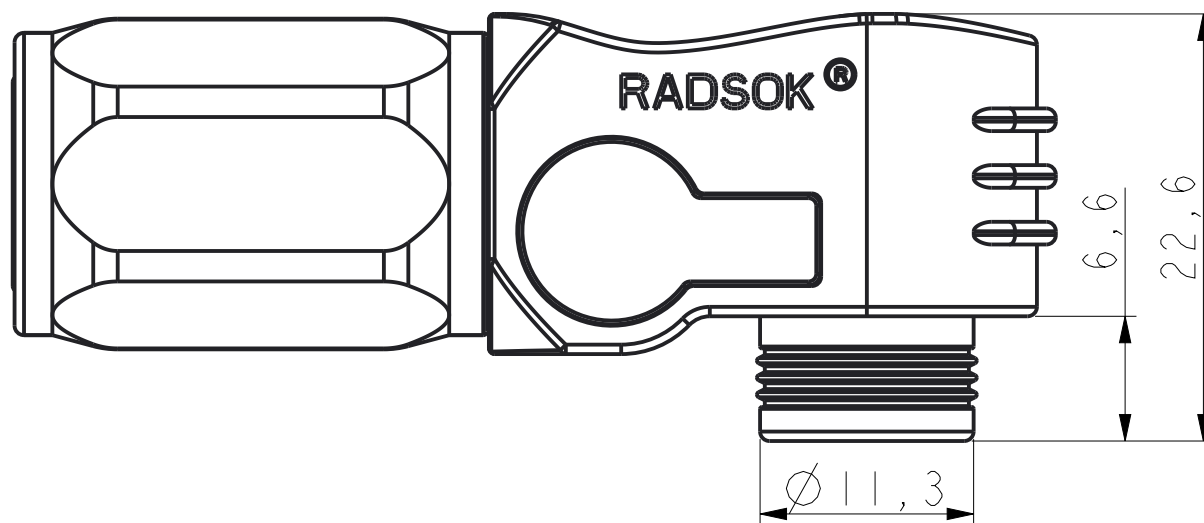
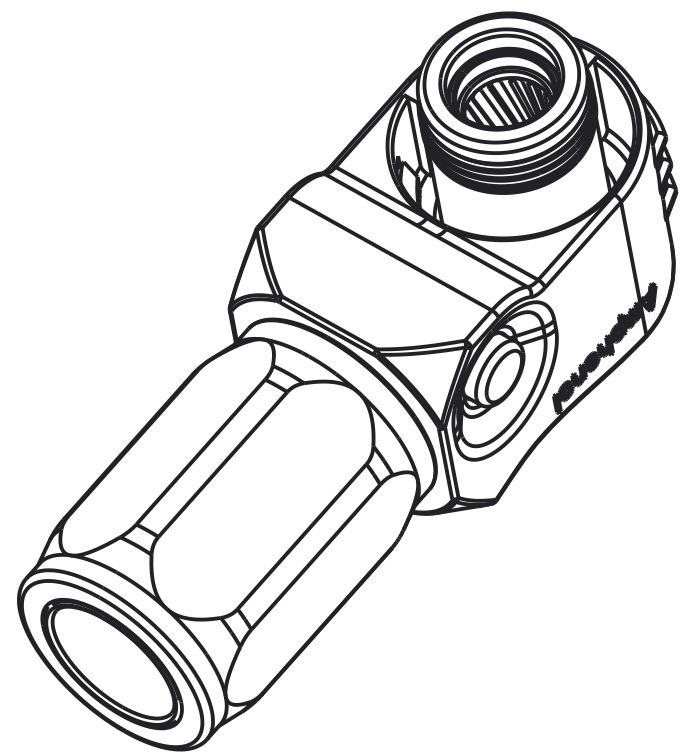

CABLE RANGE
 Ø10.2±0.2 FOR 25 MM2
 Ø8.10±0.2 FOR 16 MM2

MFG PART NUMBER: C10-730186- () () () ()

BASE NUMBER
 COLOR, SEE TABLE
 WIRE RANGE, SEE TABLE
 SEALING, SEE TABLE
 KEYWAY, SEE TABLE

CODE NUMBER REFERENCE: SLPPA () B () () ()

BASE NUMBER
 WIRE RANGE, SEE TABLE
 WITH BACKSHELL
 SEALING, SEE TABLE
 COLOR, SEE TABLE
 KEYWAY, SEE TABLE

ITEM	DESCRIPTION	CODE NUMBER	MFG NUMBER
COLOR	ORANGE	O	0
	BLACK	B	1
	RED	R	2
WIRE RANGE	25 MM2 CRIMPING	25	0
	16 MM2 CRIMPING	16	3
SEALING	IP67(MATED)	S	0
	NO SEALING	N	1
KEYWAY (Y°)	NO KEYWAY	BLANK	BLANK
	90°	0	0
	180°	1	1
	60°	2	2
	120°	3	3
	150°	4	4

SPECIFICATIONS	
CURRENT RATING	100A MAX FOR 16MM2 120A MAX FOR 25MM2
OPERATING VOLTAGE	1000V DC
OPERATING TEMPERATURE	-40°C-125°C
PROTECTION CLASS	IP67 (MATED)
PROTECTION	TOUCH PROOF

- FOR ORDERING INFORMATION, PLEASE SEE CODE NUMBER AND TABLE.
- IF CHOOSE NO SEALING TYPE, THERE WILL BE NO O-RINGS AND GROMMET.
- 16MM2 WIRE CRIMP PLUG USES THE SAME CRIMP DIE AS 25MM2, SUPPLIED WITH APRE-ASSEMBLED CRIMP REDUCER.
- THE REFERENCED PRODUCT IS IN COMPLIANCE WITH THE MAXIMUM CONCENTRATION VALUES (MCVS) AS SET BY RoHS 2.0 DIRECTIVE 2011/65/EU AND ANNEX II AMENDMENT DIRECTIVE (EU)2015/863.

NOTES:

THIS DOCUMENT CONTAINS PROPRIETARY INFORMATION AND SUCH INFORMATION MAY NOT BE DISCLOSED TO OTHERS FOR ANY PURPOSE OR USED FOR MANUFACTURING PURPOSES WITHOUT WRITTEN PERMISSION FROM THE AMPHENOL CORP.

N/A	PRO/ENGINEER INFORMATION
NEXT ASSEMBLY	Pro/e Model Used:
METRIC DOCUMENT	Drawing Name:

UNLESS OTHERWISE SPECIFIED	SPECIFICATIONS	POS	QTY	PART NUMBER	DESCRIPTION	NOTE
LINEAR DIMENSIONS ARE IN: MILLIMETERS	MATERIAL SPEC. N/A	APPROVALS		DATE	PARTS LIST	
TOLERANCES: ANGLES= ±2°	PROCESS SPEC. N/A	PREPARED BY	SEVEN XIE	10-Mar-16	AMPHENOL INDUSTRIAL OPERATIONS	
DEFAULT LINEAR TOLERANCES SEE TABLE		ENGINEER IN CHARGE	SEVEN XIE		Amphenol Technology(Zhuhai)Co.,Ltd	
DIM. & TOL. PER ASME Y14.5M-1994; DRM PER MIL-DTL-31000; OTHER AMPHENOL STANDARDS: 9-9318		DESIGN MANAGER	ROB WENG		No.63, Xinghan Road, Sanzao Town, Jinwan, Zhuhai, PRC	
LEGENDS: =FLAG NOTE CALL OUT REFERENCE ONLY		DESIGN ACTIVITY GROUP	C&I		5.7MM SURLOK PLUS RIGHTANGLE PLUG	
		THIRD ANGLE PROJECTION		SIZE C	CAGE CODE 77820	DOCUMENT NO. C10-730186-() (REV. G)
				SCALE: 1,0	REF.	SHEET 1 OF 1

DOCUMENT NO. 10-730186-() SHEET 1 OF 1 REV. G

DOCUMENT NO. 10-730186-() SHEET 1 OF 1 REV. G